



# AOASM

AMERICAN OSTEOPATHIC ACADEMY OF SPORTS MEDICINE

26th Annual Clinical Conference • April 27-30, 2011  
Westin Providence Hotel • Providence, Rhode Island

## “THE PERFORMING ARTS”

Dear Fellow Conference Attendees,

On behalf of the AOASM Board of Directors, the Executive Committee, the Program Planning Committee, and the City of Providence, I want to welcome you to the 26th Annual AOASM Clinical Conference.

This conference is very significant for a variety of reasons. First, the AOASM is the first sports medicine academy ever to dedicate an entire conference to the performing arts, an area with millions of participants but minimal dedication from the medical community to meet their needs. To that end, we are proud to have numerous members of the International Association of Dance Medicine and Science (IADMS) serving as faculty. Their organization represents dance medicine all across the world, so their presence with us this week is both humbling and appreciated.

Second, Randall Dick of the American College of Sports Medicine will join us Wednesday evening to announce AOASM's affiliation with Athletes and the Arts, an initiative started by the American College of Sports Medicine and the Center for Music Arts Entrepreneurship at Loyola University (New Orleans). The mission is to share sports medicine practices and techniques with the performing arts world, something we are doing at this very conference. Their focus is on musicians, another group of performers with many occupational hazards.

I could go on about all the amazing accomplishments of our keynote speaker, Lyle Micheli, M.D. I could mention that few conferences will have so many medical professionals at the top of their field of interest internationally, from dance to figure skating, pro wrestling to addiction medicine. I could even mention that we have several dancers teaching this week who are currently professionals, including our Rusty Wright speaker, Ray Mercer, who is on Broadway right now, and Kristen Thorne, who performs for the San Diego Ballet at night while doing physical therapy during the day—professional in both worlds.

Instead of mentioning all that, I'd rather tell you what this conference means to me. Performing arts saved me, my career, my family. Several years ago, I was letting my career consume me. I defined myself by the teams I cared for, the athletes I knew, the accomplishments I achieved, the programs I started. There was no happiness, no room for my family and friends, just an incessant and futile search for something else, something more. But in diving into performing arts, I finally found myself, discovered who I am, realized what I'm made of. I saw the futility of my behavior, the emotional disconnect with others, and I dedicated myself to a more fulfilling purpose.

So when you hear me talk about having pride in AOASM raising awareness of the medical needs of performing artists, you'll know it comes from an organic and personal place. Performing arts reflects our humanity, presents it for us to understand, and nourishes it to keep ourselves vibrant and alive. And in my case, it helped me become a better father, husband, and physician.

With that, I encourage everyone to meet as many other conference attendees as possible, and connect with those whose passion for caring, performing, or both, will inspire and excite you. You will find plenty of friends here. Enjoy yourself in Providence!

Yours truly,

Steven J. Karageanes, D.O., FAOASM  
Program Chair, AOASM 2011 Annual Clinical Conference

### AOASM Executive Committee

**President** - Phillip Zinni III, D.O., FAOASM, CMRO, ATC  
**President-Elect** - Vincent Disabella, D.O., FAOASM  
**First Vice President** - Steven J. Karageanes, D.O., FAOASM  
**Second Vice President** - Angela Cavanna, D.O., FAOASM  
**Secretary/Treasurer** - Patrick F. Leary, D.O., FAOASM, FACSM  
**Immediate Past President** - Michele Gilseman, D.O., FAOASM

### Board Members

Jeffrey R. Bytomski, D.O., FAOASM  
R. Scott Cook, D.O.  
Stephen Daquino, D.O., FAOASM  
John J. Dougherty, D.O., FAOASM  
R. Rob Franks, D.O., FAOASM  
Shawn Kerger, D.O., FAOASM  
Ed T. Kornoelje, D.O., FAOASM  
Jodi Pelegrin, D.O., ATC  
Michael J. Sampson, D.O., FAOASM  
Marcia Whalen, D.O., FAOASM

### Ex-Officio Members of the Board

Richard Parker, D.O., FAOASM  
Conjoint Board Liaison  
P. Gunnar Brolinson, D.O., FAOASM, FAFPP  
CJSM Editor  
Alan Stockard, D.O., FAOASM  
BOSS Liaison  
Susan M. Rees, M.S.  
Executive Director

### AOASM Education Planning Committee

Steven J. Karageanes, D.O., FAOASM  
AOASM 2011 Program Chair

### 2011 Planning Committee

Vincent Disabella, D.O., FAOASM  
R. Rob Franks, D.O., FAOASM  
Ed T. Kornoelje, D.O., FAOASM  
Tom Goodwin, D.O.  
Melanie Gray  
Patrick F. Leary, D.O., FAOASM, FACSM  
Brett Martin, D.O.  
Becca R. Rodriguez, D.O.  
Marcia Whalen, D.O., FAOASM

# WESTIN PROVIDENCE HOTEL

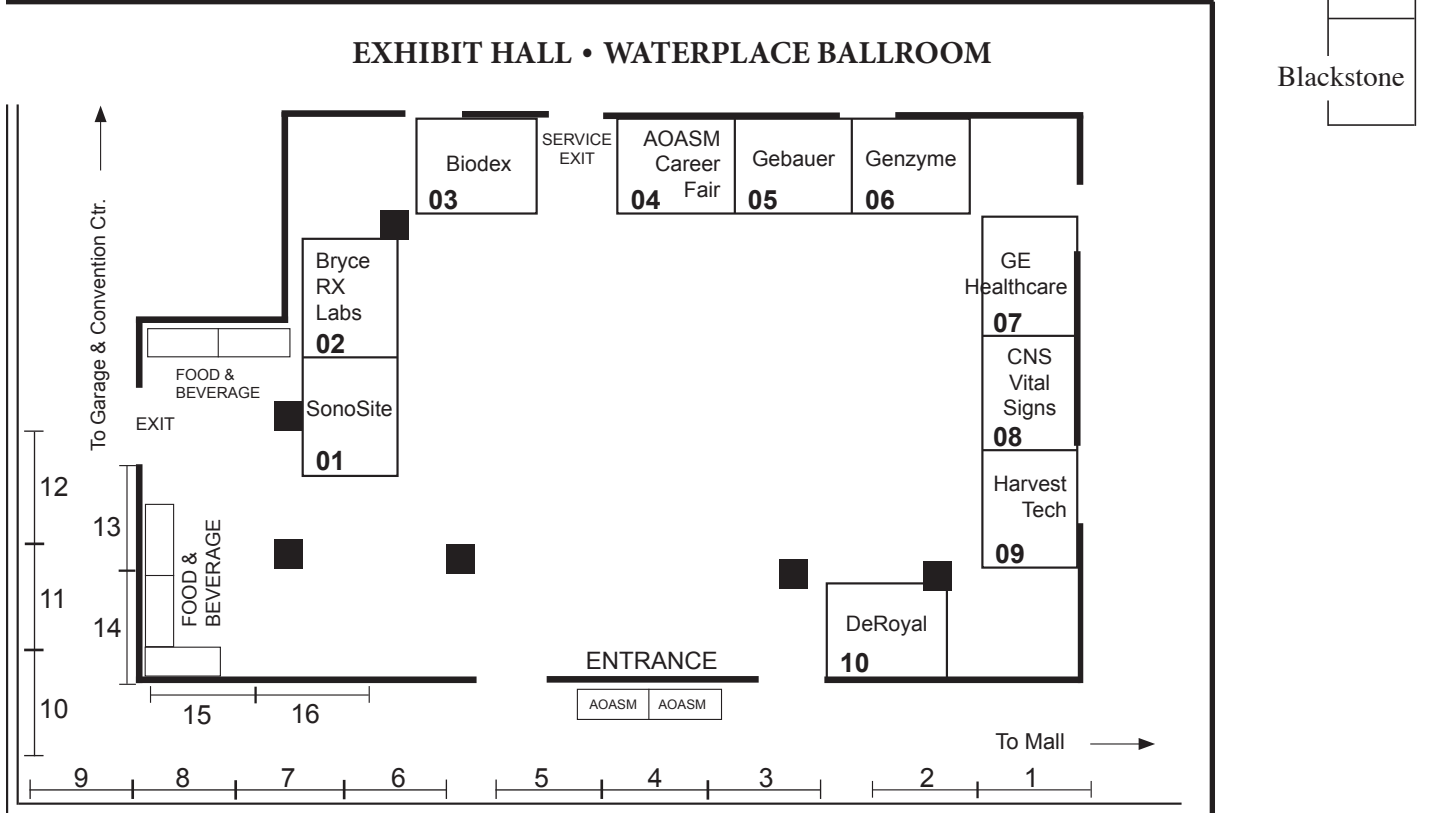
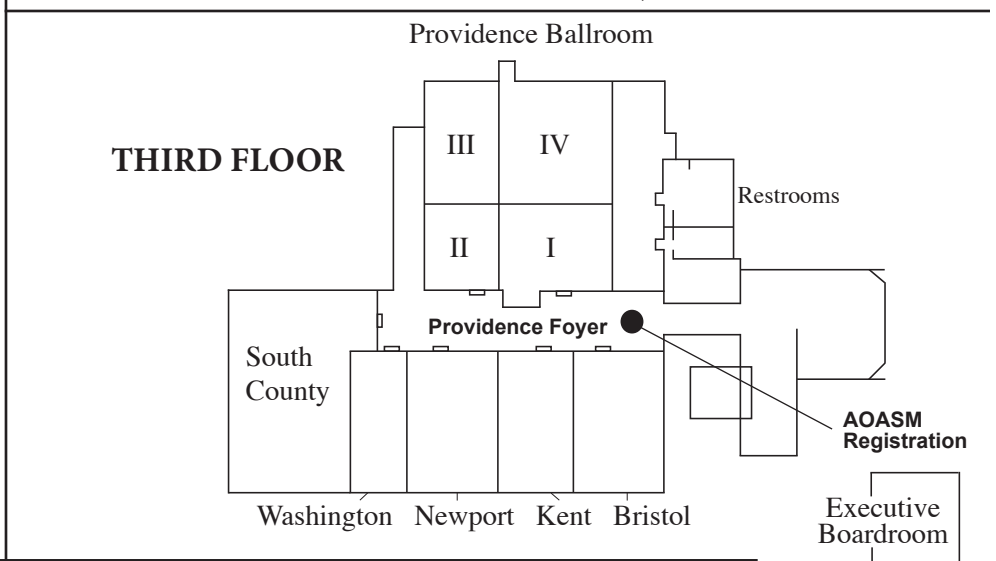
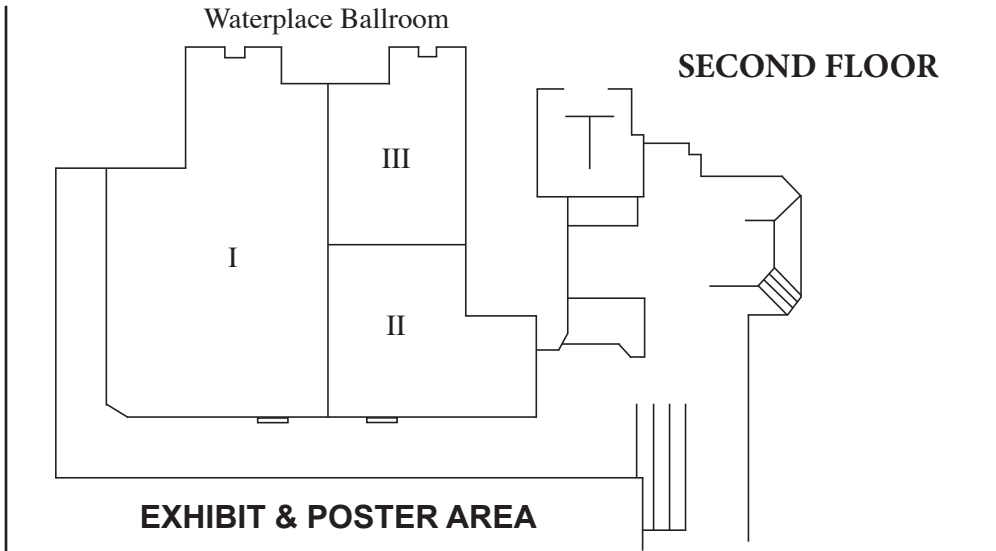
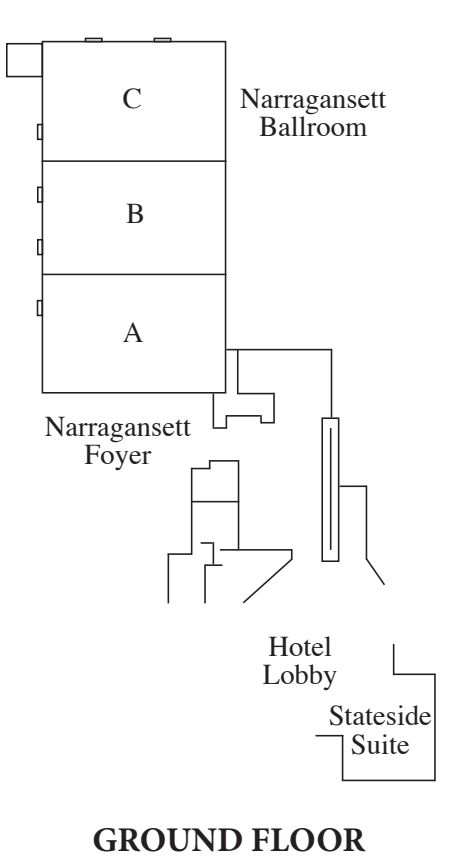

## Conference Objectives

---

At the conclusion of the conference, the participant will be able to:

- Broaden the understanding and knowledge base of the factors and techniques involved in the pathophysiology of dancer injuries;
- Expose clinicians to a wide variety of performing arts activities and their specific injury mechanisms;
- To improve clinicians' use of alternative treatments for inflammation, injury, and disease, such as nutrition, acupuncture, platelet-rich plasma, osteopathic manipulative medicine, and psychology; and
- Update clinicians on the national treatment trends for concussion.

## Registration

---

Registration will begin Tuesday, April 26 from 4:00 p.m. to 6:00 p.m. and will be open the following hours during the week of the conference:

Wednesday, April 27	7:00 a.m. – 6:00 p.m.
Thursday, April 28	7:00 a.m. – 5:00 p.m.
Friday, April 29	7:30 a.m. – 1:00 p.m.
Saturday, April 30	7:30 a.m. – 1:00 p.m.

Registration includes:

- Admission to all Conference Educational Sessions
- Refreshment Breaks
- Continental Breakfasts
- Wednesday Night Reception (cash bar)
- Conference Syllabus CD
- Access to Exhibit Area
- Usage of the OMT room
- Friday Night Dessert Reception (cash bar)

## Exhibit Hours

---

The Clinical Conference Exhibits are located in the Waterplace Ballroom. Refreshment Breaks are scheduled in the Exhibit Area throughout the Conference. We would like to thank the companies who are exhibiting with us this year. Financial support received from the exhibitors allows the AOASM to offer a quality educational conference to our members. There is not a better time to see and compare suppliers for your clinic or facility than during the Annual Clinical Conference this year. Plan to spend time looking over the products you are considering and the products you currently use.

The exhibits will be open on Wednesday, Thursday, and Friday during the following hours:

Wednesday, April 27  
6:00 p.m. - 8:30 p.m.  
Welcome Reception

Thursday, April 28  
9:00 a.m. - 4:00 p.m.

Friday, April 29  
7:00 a.m. - 11:00 a.m.

## Poster Session Hours

---

Wednesday, April 27  
6:00 p.m. - 8:30 p.m.  
(Authors present to discuss presentations)

Thursday, April 28  
7:00 a.m. - 4:00 p.m.  
(Posters on display)

Friday, April 29  
7:00 a.m. - 11:00 a.m.  
(Posters on display)

## AOASM Career Booth

---

The Career Fair booth is located in the exhibit area, booth #4 in the Waterplace Ballroom on second floor of the Westin Providence Hotel. The Career Fair will be open during exhibitor hours. Announcements will be placed as hard copies in binders for viewing located at the booth. There will be binders for *Available Positions* and *Fellowships*. Each job announcement will have a designated folder where job seekers will have the opportunity to confidentially place their CV's. Job seekers may also include their CV's in a separate binder, allowing employers to view them on-site.

## Badges

---

Your badge will admit you to all the educational sessions, refreshment breaks, and the exhibit area during the Annual Conference.

*Please Wear Your Badge at all Times!*

## Message Center

---

A message board will be set up in the AOASM registration area. Please check the board daily.

## OMT Room

---

Throughout the conference, the OMT room will be available each day, located in the Washington Meeting Room on the 3rd floor. The room will contain a few OMT tables for any attendees as needed. The hours are listed on the schedule-at-a-glance to use.

## Welcome Reception

---

On Wednesday evening, April 27, from 6:00 p.m. - 8:30 p.m., join your colleagues, visit the exhibitors, network, enjoy hors d'oeuvres and cash bar, and attend a poster session while authors are present at their poster. The reception and events will be located in the Waterplace Ballroom and foyer area.

## The Rusty Wright Keynote Lecture Luncheon

---

The Rusty Wright Memorial Lecture: The Dancer Elite will be given by Ray Mercer, Dancer/Choreographer, during lunch on Wednesday, April 27, 2011, from 12:15 p.m. to 1:25 p.m. The guest speaker is a Broadway cast member of, 'The Lion King,' Maggie Allesee Artist in Residence, at Wayne State University School of Dance and Michigan Dance Council Award Winner. (Advance ticket purchase required.)

## AOASM Award of Fellow Gala & Dessert Reception

---

The AOASM Award of Fellow Gala will be held on Friday, April 29, 2011, from 6:30 p.m. to 10:30 p.m. This will be a celebration as we induct our new Fellows into the oldest primary care sports medicine academy in the country with cash bar and dinner from 6:30 p.m. to 8:30 p.m. (Advance ticket purchase required for attending the Gala Dinner portion of this event.) The later evening celebration from 8:30 p.m. to 10:30 p.m. is open to all AOASM Conference attendees and their guests. This will include cash bar, dessert reception, AOA guest speaker, Joseph Yasso, M.D., induction of the AOASM Officers and concluding with performances of "Dancing with the D.O. Stars."

## 2011 FAOASM Inductees

---

Congratulations to the newest recipients of the distinguished AOASM Award of Fellow:

Shawn Kerger, D.O., FAOASM  
Kathryn C. Lambert, D.O., FAOASM  
Rance L. McClain, D.O., FAOASM, FACOPF

# Schedule-At-A-Glance

Tuesday, April 26, 2011

**4:00 p.m. – 6:00 p.m.**  
**Foyer - Providence Ballroom**  
AOASM Registration Open

**6:00 p.m. – 10:00 p.m.**  
**Bristol**  
AOASM Board of Directors Meeting

Wednesday, April 27, 2011

**7:00 a.m. – 6:00 p.m.**  
**Foyer - Providence Ballroom**  
AOASM Registration Open

**7:00 a.m. – 8:30 a.m.**  
**Foyer - Providence Ballroom**  
Continental Breakfast

**7:45 a.m. - 12:15 p.m.**  
**Providence Ballroom**  
AESTHETIC PERFORMING ARTS  
*Moderator: Becca R. Rodriguez, D.O.*

**7:45 a.m. - 8:00 a.m.**  
**Welcome and Introductions**  
*Phillip Zinni III, D.O., FAOASM, CRMO, ATC*  
*Steven J. Karageanes, D.O., FAOASM*

**8:00 a.m. - 9:00 a.m.**  
**Keynote Address**  
**Dance Medicine: Current Concepts**  
*Lyle Micheli, M.D.*

**9:00 a.m. – 9:30 a.m.**  
**The Dance Medicine Model**  
*Becca R. Rodriguez, D.O.*

**9:30 a.m. - 10:00 a.m.**  
**Lower Extremity Stress Injuries**  
*Henry Goitz, M.D.*

**10:00 a.m. - 10:30 a.m.**  
**Foyer - Providence Ballroom**  
Refreshment Break

**10:00 a.m. - 9:00 p.m.**  
**Washington**  
OMT Room

**10:30 a.m. - 11:00 a.m.**  
**Movement: Metaphor for Health**  
*Peter Lewton-Brain, D.O.*

**11:00 a.m. - 11:30 a.m.**  
**Dancing Through Pregnancy**  
*Ann Cowlin, MA, CSM, CCE*

**11:30 a.m. - 12:00 noon**  
**“Core” Considerations: Functional Control and Dynamic Stability for the Performing Artist**  
*Katherine Ewalt, MS, ATC, HHP, NCTM*

**12:00 noon - 12:15 p.m.**  
**Q&A**

**12:15 p.m. - 1:25 p.m.**  
**South County**  
*Moderator: Steven J. Karageanes, D.O., FAOASM*

**Rusty Wright Lecture Luncheon\***  
**The Dancer Elite**  
*Guest Speaker: Ray Mercer, Dancer & Choreographer*

\* Advance ticket purchase required.

**1:30 p.m. - 5:45 p.m.**  
**PERFORMING ARTS AFTERNOON WORKSHOPS**  
Sessions 1-14  
*Moderator: Becca R. Rodriguez, D.O.*

**1:30 p.m. – 2:30 p.m.**  
**Providence Ballroom**  
Session 1: The “Core”: Assessment and Rehabilitation Considerations for the Performing Artist  
*Katherine Ewalt, MS, ATC, HHP, NCTM*

**1:30 p.m. – 2:30 p.m.**  
**Bristol**  
Session 2: Physical Exam of the Dancer  
*Heather Southwick, PT*

**1:30 p.m. – 2:30 p.m.**  
**Kent**  
Session 3: Pointe Readiness  
*Kirsten Thorne, DPT*

**1:30 p.m. – 2:30 p.m.**  
**Newport**  
Session 4: Injuries Resulting from Improper Ballet Technique  
*Melanie Gray & Becca R. Rodriguez, D.O.*

**2:30 p.m. – 3:30 p.m.**  
**Providence Ballroom**  
Session 5: The “Core”: Assessment and Rehabilitation Considerations for the Performing Artist  
*Katherine Ewalt, MS, ATC, HHP, NCTM*

**2:30 p.m. – 3:30 p.m.**  
**Bristol**  
Session 6: Physical Exam of the Dancer  
*Heather Southwick, PT*

**2:30 p.m. – 3:30 p.m.**  
**Kent**  
Session 7: Pointe Readiness  
*Kirsten Thorne, DPT*

**2:30 p.m. – 3:30 p.m.**  
**Newport**  
Session 8: Injuries Resulting from Improper Ballet Technique  
*Melanie Gray & Becca R. Rodriguez, D.O.*

**3:30 p.m. – 3:45 p.m.**  
**Foyer - Providence Ballroom**  
Refreshment Break

**3:45 p.m. - 4:45 p.m.**  
**Providence Ballroom**  
Session 9: Taping Considerations for the Performing Artist  
*Katherine Ewalt, MS, ATC, HHP, NCTM*

**3:45 p.m. - 4:45 p.m.**  
**Newport**  
Session 10: Pelvic and Abdominal Integrity Exercises for Female Dancers/Athletes  
*Ann Cowlin, MA, CSM, CCE*

**3:45 p.m. - 4:45 p.m.**  
**Bristol/Kent**  
Session 11: Manual Medicine Techniques for Treating Dancers  
*Peter Lewton-Brian, D.O., & Carrie Janiski, D.O., ATC*

**4:45 p.m. - 5:45 p.m.**  
**Providence Ballroom**  
Session 12: Taping Considerations for the Performing Artist  
*Katherine Ewalt, MS, ATC, HHP, NCTM*

**4:45 p.m. - 5:45 p.m.**  
**Newport**  
Session 13: Pelvic and Abdominal Integrity Exercises for Female Dancers/Athletes  
*Ann Cowlin, MA, CSM, CCE*

**4:45 p.m. - 5:45 p.m.**  
**Bristol/Kent**  
Session 14: Manual Medicine Techniques for Treating Dancers  
*Peter Lewton-Brian, D.O., & Carrie Janiski, D.O., ATC*

**6:00 p.m. - 8:30 p.m.**  
**Waterplace Ballroom – 2nd floor**  
Welcome Reception  
Exhibits Open  
Poster Sessions

**Poster Presenters:**  
*Moderator: Jeffrey Bytomski, D.O., FAOASM*

1. Daniel Clearfield, D.O.
2. Richard Davis
3. Jill Friedman, D.O.
4. Patricia A. Leone, D.O.
5. Rick Margaitis, D.O.
6. Scott L. Martin, D.O.
7. Jason McHugh, D.O.
8. Michael Messmer, D.O.
9. Ben Mwanika, D.O.
10. Neesheet Parikh, D.O.
11. Shamik Patel, D.O.
12. Saunora Prom, D.O.
13. Joshua Purses, D.O.
14. Mark Sakr, D.O.
15. Mary Solomon, D.O.
16. Melissa Tabor, D.O.

*Special thanks to the poster judges this year.*

Thursday, April 28, 2011

**7:00 a.m. – 5:00 p.m.**  
**Foyer - Providence Ballroom**  
AOASM Registration Open

**7:00 a.m. – 8:30 a.m.**  
**Foyer - Providence Ballroom**  
Continental Breakfast

**7:00 a.m. - 9:00 p.m.**  
**Washington**  
OMT Room

**8:00 a.m. - 12:30 p.m.**  
**Providence Ballroom**  
SPORTS AND PERFORMANCE ISSUES  
*Moderators: Rob Franks, D.O., FAOASM,  
Michele Gilseman, D.O., FAOASM &  
Richard Parker, D.O., FAOASM*

**8:00 a.m. - 9:00 a.m.**  
**Case Presentations**

**Podium Presenters:**  
1. Daniel Day, D.O.  
2. Crystal Dyer, M.D.  
3. Francisco Laboy III, D.O.  
4. John Neidecker, D.O.  
5. Shawn Saylor, D.O.

**9:00 a.m. – 9:30 a.m.**  
**Research Presentations**

**Podium Presenters:**  
1. Crystal Dyer, M.D. & Ryan Wennell  
2. Jonathan Tait, D.O.

*Special thank you to our panel and audience  
judges this year.*

**9:00 a.m. – 4:00 p.m.**  
**Waterplace Ballroom – 2nd floor**  
Exhibit Area Open

**9:30 a.m. - 10:00 a.m.**  
**Waterplace Ballroom – 2nd floor**  
Refreshment Break/Exhibits

**10:00 a.m. - 10:30 a.m.**  
**Mens Lacrosse 101: An Introduction to the  
Sport, and Injuries to Anticipate**  
*Jason Tarno, D.O.*

**10:30 a.m. - 11:00 a.m.**  
**Lacrosse: Abdominal and Chest Injuries**  
*David Gealt, D.O.*

**11:00 a.m. - 11:30 a.m.**  
**Lacrosse: Hand and Wrist Injuries**  
*Rob Franks, D.O., FAOASM*

**11:30 a.m. - 12:15 p.m.**  
**Alan Jacobs Lecture**  
**Lacrosse: Head Injuries**  
*Margot Putukian, M.D.*

**12:15 p.m. - 12:30 p.m.**  
**Q&A**

**12:30 p.m. - 12:45 p.m.**  
**Bristol/Kent**  
CNS Vital Signs Product Theater Presentation

**12:30 p.m. - 1:25 p.m.**  
**Lunch (on your own)**

**1:30 p.m. - 6:00 p.m.**  
**OMM/OMT WORKSHOPS**  
SESSIONS 15-26  
*Moderators: Patrick F. Leary, D.O., FAOASM,  
FACSM & Carrie Janiski, D.O., ATC*

**1:30 p.m. – 2:30 p.m.**  
**Providence Ballroom**  
Session 15: EMERGENCY MEDICINE:  
Cervical Spine Injuries  
*Craig Chappell, D.O., Andrew Martin, D.O.,  
Greg Coppola, D.O. & Bradley R. Jacobson,  
M.A., ATC*

**1:30 p.m. – 2:30 p.m.**  
**Bristol/Kent**  
Session 16: EMERGENCY MEDICINE:  
Dislocations and Fractures  
*J. Troy Thompson, D.O.*

**1:30 p.m. – 2:30 p.m.**  
**Newport**  
Session 17: EMERGENCY MEDICINE:  
What's in your Bag?  
*Patrick F. Leary, D.O., FAOASM, FACSM*

**2:30 p.m. – 3:30 p.m.**  
**Providence Ballroom**  
Session 18: EMERGENCY MEDICINE:  
Cervical Spine Injuries  
*Craig Chappell, D.O., Andrew Martin, D.O.,  
Greg Coppola, D.O. & Bradley R. Jacobson,  
M.A., ATC*

**2:30 p.m. – 3:30 p.m.**  
**Bristol/Kent**  
Session 19: EMERGENCY MEDICINE:  
Dislocations and Fractures  
*J. Troy Thompson, D.O.*

**2:30 p.m. – 3:30 p.m.**  
**Newport**  
Session 20: EMERGENCY MEDICINE:  
What's in your Bag?  
*Patrick F. Leary, D.O., FAOASM, FACSM*

**3:30 p.m. – 4:00 p.m.**  
**Waterplace Ballroom – 2nd floor**  
Refreshment Break/Exhibits

**4:00 p.m. – 5:00 p.m.**  
**Providence Ballroom**  
Session 21: MANUAL MEDICINE:  
Upper Extremity  
*Carrie Janiski, D.O., ATC*

**4:00 p.m. – 5:00 p.m.**  
**Bristol/Kent**  
Session 22: MANUAL MEDICINE:  
Lower Extremity  
*Steven J. Karageanes, D.O., FAOASM*

**4:00 p.m. – 5:00 p.m.**  
**Newport**  
Session 23: PRP: Using Platelet-Rich Plasma  
Therapy  
*Tariq Awan, D.O. & Sadiq Haque, D.O.*

**5:00 p.m. – 6:00 p.m.**  
**Providence Ballroom**  
Session 24: MANUAL MEDICINE:  
Upper Extremity  
*Carrie Janiski, D.O., ATC*

**5:00 p.m. – 6:00 p.m.**  
**Bristol/Kent**  
Session 25: MANUAL MEDICINE:  
Lower Extremity  
*Steven J. Karageanes, D.O., FAOASM*

**5:00 p.m. – 6:00 p.m.**  
**Newport**  
Session 26: PRP: Using Platelet-Rich Plasma  
Therapy  
*Tariq Awan, D.O. & Sadiq Haque, D.O.*

**6:30 p.m. - 10:30 p.m.**  
**Off-site Event: Broadway Show  
West Side Story\***  
*Coordinator: Becca R. Rodriguez, D.O.*

(Meet in the Hotel Lobby by 6:45 p.m. to  
check in with the Coordinator.)  
\*Advance ticket purchase required.

Friday, April 29, 2011

**5:45 a.m. – 7:30 a.m.**  
**Off-site Event - Fun Run**  
*Coordinator: Marcia Whalen, D.O., FAOASM*  
(Meet in the Hotel Lobby by 5:45 a.m. to  
check in with the Coordinator.)

**6:45 a.m. – 7:45 a.m.**  
**Newport**  
AOASM Program Inspectors' Workshop  
*John Dougherty, D.O., FAOASM*

**7:00 a.m. – 8:30 a.m.**  
**Waterplace Ballroom – 2nd floor**  
Continental Breakfast

**7:00 a.m. – 11:00 a.m.**  
**Waterplace Ballroom – 2nd floor**  
Exhibit Area Open

**7:00 a.m. - 5:30 p.m.**  
**Executive Boardroom**  
Committee Meetings  
(This meeting space is available to schedule  
any AOASM committee meetings while onsite.  
Check with the AOASM Registration Desk for  
availability.)

**7:00 a.m. - 9:00 p.m.**  
**Washington**  
OMT Room



**7:30 a.m. – 1:00 p.m.**

**Foyer – Providence Ballroom**

AOASM Registration Open

**8:00 a.m. – 12:45 p.m.**

**Providence Ballroom**

ATHLETIC PERFORMING ARTS

*Moderator: Ed T. Kornoelje, D.O., FAOASM*

**8:00 a.m. – 8:30 a.m.**

**Concussion Management: Current Advances in the NFL and the WWE**

*Joseph Maroon, M.D.*

**8:30 a.m. – 9:00 a.m.**

**Wrestling: Coverage of the WWE: Injuries DO Happen**

*Michael Sampson, D.O., FAOASM*

**9:00 a.m. – 9:30 a.m.**

**Gymnastics: Hip Injury in Gymnastics**

*Larry Nassar, D.O., FAOASM*

**9:30 a.m. – 10:00 a.m.**

**Figure Skating: Foot and Ankle Pain in Figure Skaters**

*Stephen Goldman, D.O., FAOASM*

**10:00 a.m. – 10:30 a.m.**

**Waterplace Ballroom – 2nd floor**

Refreshment Break/Exhibits

**10:30 a.m. – 11:00 a.m.**

**Figure Skating: Neuromuscular Causes of Back Pain in Competitive Figure Skating**

*Stephen Goldman, D.O., FAOASM*

**11:00 a.m. – 11:30 a.m.**

**Roller Derby: The Sport, the Myth, the Legend...and the Injuries**

*Mike Messmer, D.O.*

**11:30 a.m. – 12:00 noon**

**Roller Derby: Injury Patterns**

*Ed T. Kornoelje, D.O., FAOASM*

**12:00 noon – 12:15 p.m.**

**Q&A**

**12:15 p.m. – 12:45 p.m.**

**AOASM Business Meeting**

*Phillip Zinni III, D.O., FAOASM, CRMO, ATC*

*Steven J. Karageanes, D.O., FAOASM*

**12:45 p.m. – 1:25 p.m.**

**Lunch (on your own)**

**12:45 p.m. – 1:25 p.m.**

**South County**

Fellow/Resident Luncheon

(By Invitation Only)

**12:45 p.m. – 1:25 p.m.**

**Kent**

Student Luncheon

(By Invitation Only)

**1:30 p.m. – 5:00 p.m.**

**AFTERNOON WORKSHOPS \***

*Moderators: Stephen Daquino, D.O., FAOASM & Rob Franks, D.O., FAOASM*

\*Physicians & Allied Health Professionals have the option of the afternoon off or attending the Fellow/Resident/Student Workshops for additional CME credit hours.

**1:30 p.m. – 3:00 p.m.**

**Providence Ballroom**

Improving Major Depressive Disorder (MDD) Treatment Outcome (Tailoring Strategies for Remission)\*

*Guest Speaker: C. Brendan Montano, M.D.*

**\*Commercial Support Acknowledgement:**

This activity is supported by an educational grant from AstraZeneca.

**2:00 p.m. – 4:00 p.m.**

**Newport**

Program Directors' Workshop

*John Dougherty, D.O., FAOASM*

**3:00 p.m. – 3:30 p.m.**

**Providence Ballroom**

Fellow/Resident/Student Workshop:

Professional Communications - How to Write

**3:30 p.m. – 4:30 p.m.**

**Providence Ballroom**

Student Workshop

**3:30 p.m. – 4:30 p.m.**

**Bristol/Kent**

Fellow/Resident Workshop

**4:30 p.m. – 5:00 p.m.**

**Providence Ballroom**

Student Relations Committee Meeting

**4:30 p.m. – 5:30 p.m.**

**Executive Boardroom**

2012 Program Committee Meeting

2012 Program Chair: Angela Cavanna, D.O.,

FAOASM

**6:30 p.m. – 8:30 p.m.**

**Narragansett Ballroom A – 1st floor**

Award of Fellow Gala Dinner

(Advance ticket purchase required.)

**8:30 p.m. – 10:30 p.m.**

**Narragansett Ballroom A – 1st floor**

(Attendees and guests are invited to join the AOASM dessert reception and evening presentations. No ticket required.)

Dessert Reception

Cash Bar

*AOA Guest Speaker: Joseph Yasso, M.D.*

Induction of Officers

Dancing with the D.O. Stars

Saturday, April 30, 2011

**7:00 a.m. – 8:30 a.m.**

**Foyer - Providence Ballroom**

Continental Breakfast

**7:00 a.m. - 10:30 a.m.**

**Washington**

OMT Room

**7:30 a.m. – 1:00 p.m.**

**Foyer - Providence Ballroom**

AOASM Registration Open

**8:00 a.m. – 10:00 a.m.**

**Providence Ballroom**

THE PRICE OF PERFORMANCE

*Moderators: Brett Martin, D.O. &*

*Tom Goodwin, D.O.*

**8:00 a.m. - 8:30 a.m.**

**End-Stage Hip Disease & Arthritis**

*John Dougherty, D.O., FAOASM*

**8:30 a.m. - 9:00 a.m.**

**Osteoporosis: Diagnosis and Treatment**

*Brett Martin, D.O.*

**9:00 a.m. - 9:30 a.m.**

**Prevalence of Cardiovascular Risk Factors**

**Among National Football League Players**

*Thomas Allen, D.O, M.P.H., FAOASM, FACP,*

*FACOI*

**9:30 a.m. - 10:00 a.m.**

**Psychosocial Disorders:**

**Sex, Drugs, and Athletes**

*Reef Karim, D.O.*

**10:00 a.m. - 10:30 a.m.**

**Foyer – Providence Ballroom**

Refreshment Break

**10:30 a.m. – 12:30 p.m.**

**Providence Ballroom**

ENHANCING PERFORMANCE

*Moderators: Brett Martin, D.O. &*

*Tom Goodwin, D.O.*

**10:30 a.m. - 11:00 a.m.**

**Mental Performance:**

**Alcohol - What We Need to Know**

*Reef Karim, D.O.*

**11:00 a.m. - 11:30 a.m.**

**Nutrition Control of Inflammation**

*Michele Neil, D.O.*

**11:30 a.m. - 12:00 noon**

**PRP and Prolotherapy - Any Evidence?**

*Clifford Stark, D.O.*

**12:00 noon - 12:30 p.m.**

**Q&A**

**12:30 p.m.**

**Meeting Adjourns**

## Off-site Events

---

Fun Run – 5:30 a.m. – 7:30 a.m.

On Friday, April 29, 2011, 5:30 a.m. to 7:30 a.m., AOASM will host the annual 2011 Fun Run. Attendees should meet in the hotel lobby between 5:30 a.m. to 5:45 a.m. to enjoy a morning run along the river in beautiful Providence. The group run will leave the Hotel by 6:00 a.m. sharp. Fun Run coordinator: Marcia Whalen, D.O., FAOASM.

## West Side Story – Broadway Musical

---

On Thursday, April 28, 2011, 6:30 p.m. to 10:30 p.m., the AOASM has planned for attendees to see the legendary Broadway musical at the beautiful Providence Performing Arts Center (PPAC), and after the show a Q&A with some of the cast. The show will begin at 7:30 p.m. and it lasts approximately 2 hours and 40 minutes, including intermission. If you have registered for the West Side Story Broadway Show, please meet in the hotel lobby entrance, between 6:30 p.m. to 6:45 p.m. to check in with the off-site coordinator, Becca R. Rodriguez, D.O. PPAC is located at 220 Weybosset Street #2, which is in walking distance from the Westin Hotel or a short cab ride. Advance ticket purchase required.

## Evaluation Form

---

Your meeting evaluation form is located at:

<http://www.surveymonkey.com/s/2011AOASMConferenceEval>

Please take time to comment on the meeting. We listen to what you have to say, and we try to incorporate your comments and suggestions into future meetings. Please complete the evaluation form before May 31, 2011.

## CME and CE Credit Requirements

---

**CME Credits:** In order to receive Category-1A CME Credits, you must complete a CME Reporting Form and turn it into the AOASM. Attendees do not need to sign in for CME Credits.

**CE (BOC) Credits:** Please note that you must sign in *every day* at the AOASM Registration Desk in order to receive continuing education credit. You will be asked to provide your BOC number. In addition, you must complete a CE Reporting Form and turn it into the AOASM. Please note all athletic trainers must self-report CE activity to the BOC National Office annually.

## SPECIAL THANKS

---

The following companies/organizations are instrumental in supporting the AOASM Clinical Conference. Our gratitude is extended to each firm.

AstraZeneca  
Concussion Vital Signs  
DanceMedia  
Gebauer Company  
SonoSite Inc.  
The France Foundation

Our sincere thanks to the following people for their generous contributions to the AOASM 2011 Scholarship Fund. Your contributions allow AOASM to sponsor registrations for students who actively contribute to the association. (Donations received prior to April 8, 2011.)

John C. Biery, Sr., D.O., FAOASM, FACSM  
Anthony Biggs, D.O., MS, ATC, CSCS  
Angela C. Cavanna, D.O., FAOASM  
Douglas P. Dietzel, D.O.  
Timothy P. Duffey, D.O., FAOASM  
David D. Dyck, Jr., D.O., FAOASM  
Wayne R. English, Jr., D.O., FAOASM  
R. Robert Franks, Jr., D.O., FAOASM  
James F. Frommer, D.O., ATC  
Barry Garcia, D.O., FAOASM  
Michele T. Gilseman, D.O., FAOASM  
Shawn Kerger, D.O., FAOASM  
Albert J. Kozar, D.O., FAOASM  
James M. Lally, D.O., M.M.M., FAOASM  
Steven Landfish, D.O.  
Patrick F. Leary, D.O., FAOASM, FACSM, FACOFP, FAAFP  
Richard A. Parker, D.O., FAOASM  
Joseph Reyes, D.O.  
E. Lee Rice, D.O., FAOASM  
Michael J. Sampson, D.O., FAOASM  
Joel D. Stein, D.O., FAAO, FAOASM, FACOFP  
David Michael Wallace, D.O.  
Marcia Whalen, D.O., FAOASM  
Phillip C. Zinni III, D.O., FAOASM, ATC

## Future AOASM Meeting:

---

Marriott Louisville Downtown Hotel, Louisville, KY  
April 18-22, 2012

# 2011 AOASM Clinical Conference Exhibitors

## April 27-April 29, 2011

The Exhibit Area is located in the Waterplace Ballroom. It is also the site for the poster sessions, resources table, and Career Fair booth. Note that the refreshment breaks during the conference will be located in the exhibit area on Thursday, April 28 and Friday, April 29. Please plan time to stop by and visit with the exhibiting companies, who lend valuable financial support to the AOASM Conference.

### **Biodex Medical Systems, Inc. – Booth # 3**

210 Ramsay Rd.  
Shirley, NY 11967  
Contact Name(s): Bill Galway  
Phone: 1-631-924-9000 Fax: 1-631-924-9241  
Email: info@biodex.com  
Website: www.biodex.com

Biodex, a leader in sports medicine and rehabilitation, introduces the Play It S.A.F.E. Concussion Management Program, a “turn-key” solution to the assessment of concussion. Cognitive and functional assessments are combined using the Biodex BioSway or Balance System SD and the cognitive tool of choice. (www.biodex.com/concussion)

### **Bryce Rx Laboratories, Inc. – Booth # 2**

30 Buxton Farms Road  
Stamford, CT 06905  
Contact Name(s): Lisa Waddington  
Phone: 1-203-359-6323 Fax: 1-203-359-6448  
Email: lisa@brycerx.com  
Website: www.brycerx.com

Bryce Rx Laboratories, Inc. is a compounding only pharmacy and specializes in the formulation of drugs that are not commercially available, require alternate delivery systems, dosing changes, etc. Bryce Labs is able to tailor a prescription specifically for each of your patients.

### **Concussion Vital Signs - Booth # 8**

598 Airport Blvd., Suite 1400  
Morrisville, NC 27560  
Contact Name(s): Cary Rogers  
Phone: 1-888-750-6941 Fax: 1-888-650-6795  
Email: support@concussionvitalsigns.com  
Website: www.concussionvitalsigns.com

Concussion Vital Signs is a scientifically valid, reliable and affordable web-based sports concussion assessment platform that provides clinicians with a brief-core neurocognitive baseline and post-injury testing solution, a self-reported history, and post-concussion symptom rating scales with are used in assessing, monitoring, and managing concussions. (Contact www.concussionvitalsigns.com or +1-888-750-6941 for more information.)

### **DeRoyal – Booth # 10**

200 Debusk Lane  
Powell, TN 37849  
Contact Name(s): Dave Gallacher, James Reibeling or Maureen Quinlan  
Phone: 1-888-938-7828 Fax: 1-865-362-3762  
Email: jreibeling@deroyal.com  
Website: www.deroyal.com

Formed in 1973, DeRoyal is an international provider of healthcare products and services. Among its more than 25,000 products are disposable surgical supplies, unitized delivery systems, orthopedic soft and hard goods, rehabilitation and therapy devices, and wound care products.

### **Gebauer Company – Booth # 5**

4444 East 153rd Street  
Cleveland, OH 44128  
Contact Name(s): Cyndy Glynn or Erin Livingstone  
Phone: 1-800-321-9348 Fax: 1-216-581-4970  
Email: information@gebauer.com  
Website: www.gebauer.com

Gebauer's Spray and Stretch topical anesthetic skin refrigerant fine stream spray is to be used in conjunction with the spray and stretch technique to manage myofascial pain syndromes, trigger points, restricted motions, and muscle spasms. Rx only.

### **GE Healthcare – Ultrasound -- Booth # 7**

9900 Innovation Drive  
Wauwatosa, WI 53226  
Contact Name(s): Kathy Morris or Jeff Stahl  
Phone: 1-888-526-5144 Fax: 1-414-918-8568  
Email: cs-us@ge.com  
Website: www.geultrasound.com

GE is making a new commitment to health. Healthymagination will change the way we approach healthcare, with more than 100 innovations all focused on addressing three critical needs: lowering costs, touching more lives and improving quality. For more information, visit our website at www.gehealthcare.com.

### **Genzyme Biosurgery – Booth #6**

55 Cambridge Parkway  
Cambridge, MA 02142  
Contact Name: James Forker  
Phone: 1-401-261-7127 Fax: 1-617-761-8789  
Email: James.forker@genzyme.com  
Website: www.genzyme.com

Genzyme Biosurgery develops and markets innovative, biologically based products for health conditions that are often difficult and expensive to manage. Our current product lines are used for osteoarthritis relief, adhesion prevention, cartilage repair, and severe burn treatment.

### **Harvest Technologies Corp. – Booth # 9**

40 Grissom Road  
Suite 100  
Plymouth, MA, 02360  
Contact Name(s): Chris Herbert  
Phone: 1-508-732-7500 Fax: 1-502-738-0400  
Email: info@harvesttech.com  
Website: www.harvesttech.com

The SmartPREP 2 System from Harvest produces an Autologous Platelet Concentrate enriched with growth factors and white blood cells, at 4X baseline or greater to help optimize the conditions for tissue repair and regeneration.

### **SonoSite, Inc. – Booth # 1**

21919 – 30th Drive SE  
Bothell, WA 98021  
Contact Name(s): Joe Cygan, ATC, or Stephanie Sartz  
Phone: 1-425-951-1397 Fax: 1-425-951-1201  
Email: admin@sonosite.com  
Website: www.sonosite.com

SonoSite is the world leader and specialist in hand-carried and mountable ultrasound, as well as the industry leader in impedance cardiography equipment.